



Cross-Roller Guide/Ball Guide

THK General Catalog

A Product Descriptions

Features and Types	A7-2
Features of the Cross-Roller Guide/Ball Guide ..	A7-2
• Structure and Features	A7-2
Types of the Cross-Roller Guide/Ball Guide ..	A7-3
• Types and Features	A7-3
Point of Selection	A7-4
Rated Load and Nominal Life	A7-4
Accuracy Standards	A7-7
Dimensional Drawing, Dimensional Table	
Cross-Roller Guide Model VR (VR1) ..	A7-8
Cross-Roller Guide Model VR (VR2) ..	A7-10
Cross-Roller Guide Model VR (VR3) ..	A7-12
Cross-Roller Guide Model VR (VR4) ..	A7-14
Cross-Roller Guide Model VR (VR6) ..	A7-16
Cross-Roller Guide Model VR (VR9) ..	A7-18
Cross-Roller Guide Model VR (VR12) ..	A7-20
Cross-Roller Guide Model VR (VR15) ..	A7-22
Cross-Roller Guide Model VR (VR18) ..	A7-24
Ball Cage Model B	A7-26
Point of Design	A7-28
Installation Procedure	A7-28
Example of Clearance Adjustment	A7-29
Preload	A7-29
Accuracy of the Mounting Surface	A7-29
Options	A7-30
Dedicated Mounting Bolt	A7-30
Model No.	A7-31
• Model Number Coding	A7-31
• Notes on Ordering	A7-32
Precautions on Use	A7-33

B Support Book (Separate)

Features and Types	B7-2
Features of the Cross-Roller Guide/Ball Guide ..	B7-2
• Structure and Features	B7-2
Types of the Cross-Roller Guide/Ball Guide ..	B7-3
• Types and Features	B7-3
Point of Selection	B7-4
Rated Load and Nominal Life	B7-4
Mounting Procedure	B7-7
Installation Procedure	B7-7
Example of Clearance Adjustment	B7-8
Preload	B7-8
Accuracy of the Mounting Surface	B7-8
Options	B7-9
Dedicated Mounting Bolt	B7-9
Model No.	B7-10
• Model Number Coding	B7-10
• Notes on Ordering	B7-11
Precautions on Use	B7-12

Features of the Cross-Roller Guide/Ball Guide

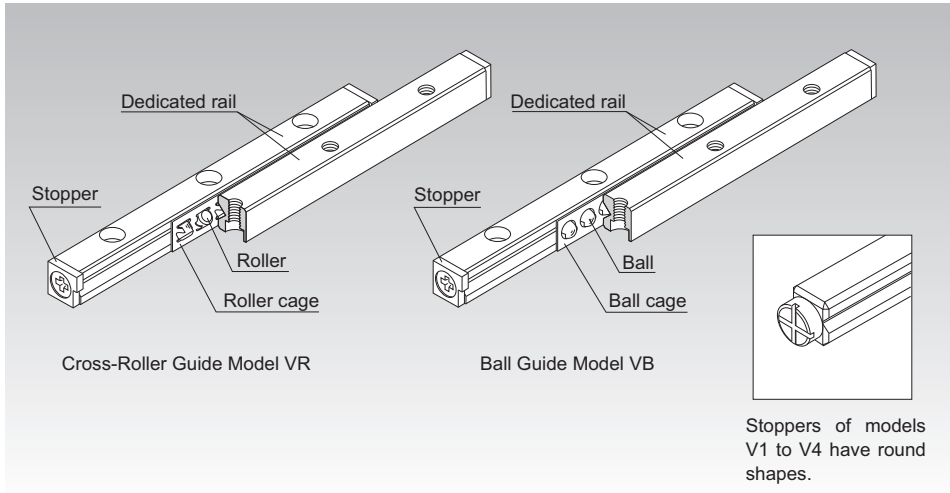

Fig.1 Structure of Cross-Roller Guide Model VR and Ball Guide Model VB

Structure and Features

In the Model VR, precision rollers are orthogonally aligned one after another in a roller cage that is combined with a dedicated rail that has a raceway cut into a 90° V-shaped groove. When two cross-roller guides are mounted in parallel, they are capable of receiving loads in four directions. In addition, the cross-roller guide can be given a preload to achieve a clearance-free, highly rigid, and smooth slide mechanism.

Model VB is a low-friction, high-accuracy, finite LM system consisting of precision steel balls, arranged in short pitches in a ball cage model B, and a dedicated rail model V.

The Cross-Roller Guide and the Ball Guide are used in the slide unit of various devices such as OA equipment and its peripherals, measuring instruments, precision equipment including a printed circuit board drilling machine, optic measuring machines, optic stages, handling mechanisms and X-Ray machines.

Features and Types

Types of the Cross-Roller Guide/Ball Guide

[Long Service Life, High Rigidity]

With a unique roller retaining mechanism, the effective contact length of the rollers is 1.7 times greater than the conventional type. Furthermore, the roller pitch interval is short and a sufficient number of rollers are installed, thereby doubling the rigidity and increasing the service life by a factor of 6. As a result, a safety-oriented design against vibrations and impacts, which commonly occur in ordinary linear motion mechanisms, can be achieved.

[Smooth Motion]

With model VR, the rollers are individually held in a cage and roller pockets formed on the cage are in surface contact with the rollers to increase grease retention. Thus, smooth motion with little wear and friction is achieved.

[Highly Corrosion Resistant]

Model VR series and model VB series both include types made of stainless steel, which is highly corrosion resistant.

Types of the Cross-Roller Guide/Ball Guide

Types and Features

Cross-Roller Guide Model VR

Specification Table⇒ [A7-8](#)

A compact, highly rigid LM system whose roller cage holding precision rollers orthogonally aligned one after another travels by half the stroke on a V-shaped groove formed on a rail.

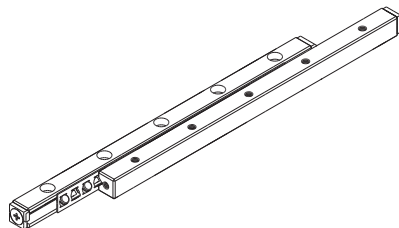

Model VR

Ball Guide Model VB

Specification Table⇒ [A7-26](#)

A low-friction, highly accurate LM system whose ball cage holding precision balls in short pitches travels by half the stroke on a V-shaped groove formed on a rail.

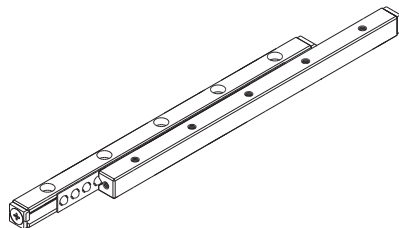

Model VB

Rated Load and Nominal Life

[Rated Loads in All Directions]

The basic load ratings (C_z and C_{0z}) in the specification table indicate the values per rolling element in the directions shown in the figure. When obtaining the nominal life, calculate the basic load ratings (C and C_0) of the actually used rolling elements from the equation below.

C_z : Basic dynamic load rating per rolling element in the specification table (kN)

C_{0z} : Basic static load rating per rolling element in the specification table (kN)

Z : Number of rolling elements used (number of rolling elements within the effective load range)

P : Roller pitch (Refer to pages **A7-8** to **A7-25**)

● For Model VR

Load direction		
Basic dynamic load rating C (kN)	$C = C_L = \left\{ \left(\frac{Z}{2} - 1 \right) \times 2P \right\}^{\frac{1}{36}} \times \left(\frac{Z}{2} \right)^3 \times C_z$	$C_T = 2^{\frac{7}{9}} \times \left\{ \left(\frac{Z}{2} - 1 \right) \times 2P \right\}^{\frac{1}{36}} \times \left(\frac{Z}{2} \right)^3 \times C_z$
Basic static load rating C_0 (kN)	$C_0 = C_{0L} = \frac{Z}{2} \times C_{0z}$	$C_{0T} = 2 \times \frac{Z}{2} \times C_{0z}$

Note: For $\frac{Z}{2}$, truncate the decimals.

● For Model VB

Load direction		
Basic dynamic load rating C (kN)	$C = C_L = Z^{\frac{2}{3}} \times C_z$	$C_T = 2 \times Z^{\frac{2}{3}} \times C_z$
Basic static load rating C_0 (kN)	$C_0 = C_{0L} = Z \times C_{0z}$	$C_{0T} = 2 \times Z \times C_{0z}$

Point of Selection

Rated Load and Nominal Life

[Static Safety Factor f_s]

Models VR and VB may receive an unexpected external force while it is stationary or operative due to the generation of an inertia caused by vibrations and impact or start and stop. It is necessary to consider a static safety factor against such a working load.

$$f_s = \frac{C_0}{P_c}$$

f_s : Static safety factor (see Table1)
 C_0 : Basic static load rating (kN)
 P_c : Calculated load (kN)

Table1 Estimates of the Static Safety Factor (f_s)

Load conditions ¹	Lower limit of f_s
Without vibration or impact	1 to 1.3
With vibration or impact	2 to 3

¹ Vibrations and impacts are typically caused by factors such as acceleration and deceleration, sudden starting and stopping, vibrations and impacts from an external machine, and changes in processing power over time.

[Calculating the Nominal Life]

The nominal life is defined as 50 km for a THK LM Guide with balls and 100 km for a cross-roller guide. The nominal life (L_{10}) is calculated from the basic dynamic load rating (C) and the load acting on the LM Guide (P_c) using the following formulas.

- LM Guide with balls (50 km basic dynamic load rating)

$$L_{10} = \left(\frac{C}{P_c}\right)^3 \times 50 \quad \dots\dots\dots(1)$$

L_{10} : Nominal life (km)
 C : Basic dynamic load rating (kN)
 P_c : Calculated load (kN)

- LM Guide with rollers (100 km basic dynamic load rating)

$$L_{10} = \left(\frac{C}{P_c}\right)^{\frac{10}{3}} \times 100 \quad \dots\dots\dots(2)$$

When comparing the nominal life (L_{10}), you must take into account whether the basic dynamic load rating was defined based on 50 km or 100 km. Convert the basic dynamic load rating based on ISO 14728-1 as necessary.

ISO-regulated basic dynamic load rating conversion formulas:

- LM Guide with balls

$$C_{100} = \frac{C_{50}}{1.26}$$

C_{50} : Basic dynamic load rating based on a nominal life of 50 km

- LM Guide with rollers

$$C_{100} = \frac{C_{50}}{1.23}$$

C_{100} : Basic dynamic load rating based on a nominal life of 100 km

[Calculating the Modified Nominal Life]

During use, a cross-roller guide/ball guide may be subjected to vibrations and shocks as well as fluctuating loads, which are difficult to detect. In addition, the surface hardness of the raceways, the operating temperature, and having blocks arranged directly behind one another will have a decisive impact on the service life. Taking these factors into account, the modified nominal life (L_{10m}) can be calculated according to the following formulas (3) and (4).

- Modified factor α

$$\alpha = \frac{f_r}{f_w}$$

α : Modified factor
 f_r : Temperature factor (see Fig. 1 on **A7-6**)
 f_w : Load factor

(see Table 2 on **A7-6**)

• Modified nominal life L_{10m}

- LM Guide with balls

$$L_{10m} = \left(\alpha \times \frac{C}{P_c} \right)^3 \times 50 \quad \dots\dots\dots(3)$$

L_{10m} : Modified nominal life (km)

C : Basic dynamic load rating (kN)

P_c : Calculated load (kN)

- LM Guide with rollers

$$L_{10m} = \left(\alpha \times \frac{C}{P_c} \right)^{\frac{10}{3}} \times 100 \quad \dots\dots\dots(4)$$

[Calculating the Service Life Time]

When the nominal life (L_{10}) has been obtained, if the stroke length and the number of reciprocations per minute are constant, the service life time is obtained using the following equation.

$$L_h = \frac{L_{10} \times 10^6}{2 \times l_s \times n_1 \times 60}$$

L_h : Service life time (h)

l_s : Stroke length (mm)

n_1 : Number of reciprocations per minute (min^{-1})

● f_T : Temperature Factor

If the temperature of the environment surrounding the operating model VR or VB exceeds 100 °C, take into account the adverse effect of the high temperature and multiply the basic load ratings by the temperature factor indicated in Fig. 1.

Note: If the environment temperature exceeds 100°C, contact THK.

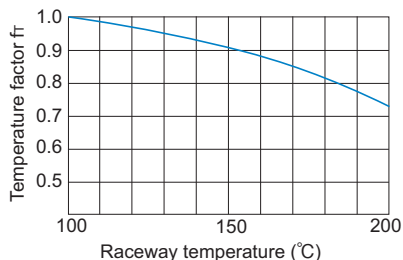

Fig.1 Temperature Factor (f_T)

● f_w : Load Factor

In general, reciprocating machines tend to experience vibrations or impacts during operation, and it is difficult to accurately determine the vibrations generated during high-speed operation and impacts during frequent starts and stops. Therefore, when the actual load applied to a Model VR or VB cannot be obtained, or when speed and vibrations have a significant influence, divide the basic dynamic load rating (C) by the corresponding load factor in Table 2, which has been empirically obtained.

Table 2 Load Factor (f_w)

Vibrations/impact	Speed (V)	f_w
Faint	Very low $V \leq 0.25\text{m/s}$	1 to 1.2
Weak	Slow $0.25 < V \leq 1\text{m/s}$	1.2 to 1.5

Accuracy Standards

The accuracy of the dedicated rail for the Cross-Roller Guide is classified into high accuracy grade (H) and precision grade (P) as shown in Table3.

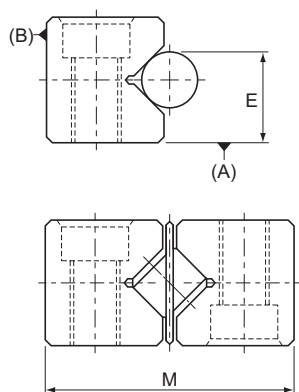

Fig.2

Table3 Accuracy Standards for Dedicated Rail Model V
Unit: mm

Accuracy grades	High-accuracy grade	Precision grade
Symbol	H	P
Item	As per Fig.3	
Parallelism of the raceway against surfaces A and B	As per Fig.3	
Dimensional tolerance in height E	± 0.02	± 0.01
Difference in height E ^(note)	0.01	0.005
Dimensional tolerance in width M	0 -0.2	0 -0.1

Note: The difference in height E applies to four rails used on the same plane.

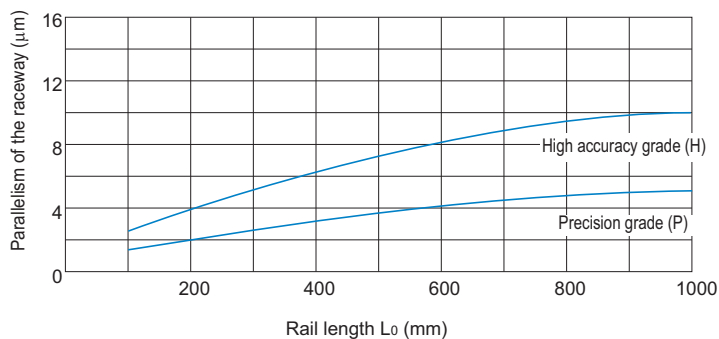
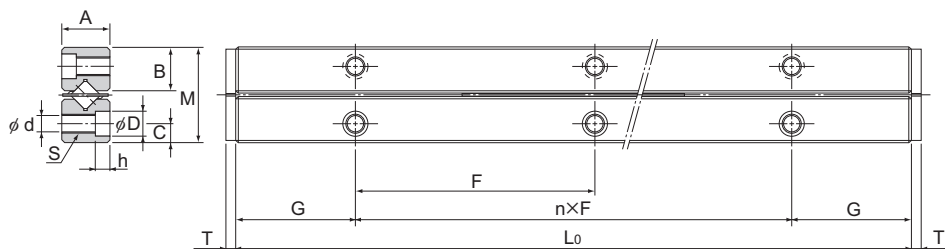

Fig.3 Rail Length and Parallelism of the Raceway

Cross-Roller Guide Model VR (VR1)



Model No.	Maximum stroke	Main dimensions								
		Combined dimensions			Mounting dimensions					
		M	A	L ₀	n×F	G	B	C	S	d
VR 1-20×5Z	12	8.5	4	20	1×10	5	3.9	1.8	M2	1.65
VR 1-30×7Z	22			30	2×10					
VR 1-40×10Z	27			40	3×10					
VR 1-50×13Z	32			50	4×10					
VR 1-60×16Z	37			60	5×10					
VR 1-70×19Z	42			70	6×10					
VR 1-80×21Z	52			80	7×10					

Model number coding

VR1 -30 H × 8Z

|
 | Accuracy symbol
 | Dedicated rail dimension in mm
 | (example of indication for a combination of different overall lengths: 40/50)
 | Combined model number (for Ball Guide: VB)

Note: "1 set" for the above model indicates a single combination of 4 rails and 2 cages.

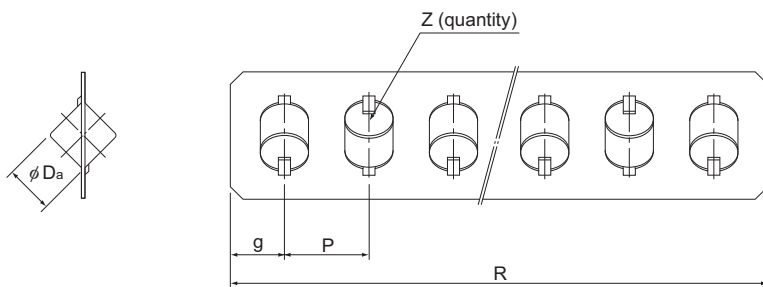

Unit: mm

								Permissible preload δ μm	Basic load rating (per roller)		Mass (rail) kg/m
				No. of rollers Z					C_z kN	C_{oz} kN	
D	h	T	D_a	R	g	P	Z				
3	1.4	1.6	1.5	14	2	2.5	5	-2	0.152	0.153	0.11
				19			7				
				26.5			10				
				34			13				
				41.5			16				
				49			19				
				54			21				

Notes: When desiring a Ball Guide in combination with a ball cage, refer to **A7-26** on Ball Cage Model B and indicate the required number of balls.

(Example) VB1-50H x $\overset{\text{Number of balls}}{12Z}$

The mass in the table indicates the value per rail/m.

Stainless steel type with high corrosion resistance is also available. (symbol M, e.g., VR1M)

To fix the dedicated rail of model VR1, use cross-recessed screws for precision equipment (No. 0 screw).

Model No.	Type	Nominal name of screw \times pitch
For model VR1	No. 0 pan-head screw ¹ (class 3)	M1.4 \times 0.3

¹ Japan Camera Industry Association Standard JCIS 10-70
Cross-recessed screw for precision equipment (No. 0 screw)

Cross-Roller Guide Model VR (VR2)

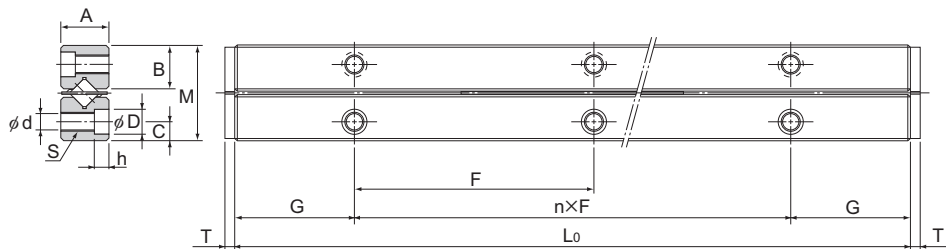

Model No.	Maximum stroke	Main dimensions								
		Combined dimensions			Mounting dimensions					
		M	A	L ₀	n×F	G	B	C	S	d
VR 2- 30×5Z	18	12	6	30	1×15	7.5	5.6	2.5	M3	2.55
VR 2- 45×8Z	24			45	2×15					
VR 2- 60×11Z	30			60	3×15					
VR 2- 75×13Z	44			75	4×15					
VR 2- 90×16Z	50			90	5×15					
VR 2-105×18Z	64			105	6×15					
VR 2-120×21Z	70			120	7×15					
VR 2-135×23Z	84			135	8×15					
VR 2-150×26Z	90			150	9×15					
VR 2-165×29Z	96			165	10×15					
VR 2-180×32Z	102			180	11×15					

Model number coding

VR2 -30 H × 6Z

Number of rollers or balls

Accuracy symbol

Dedicated rail dimension in mm

(example of indication for a combination of different overall lengths: 90/105)

Combined model number (for Ball Guide: VB)

Note: "1 set" for the above model indicates a single combination of 4 rails and 2 cages.

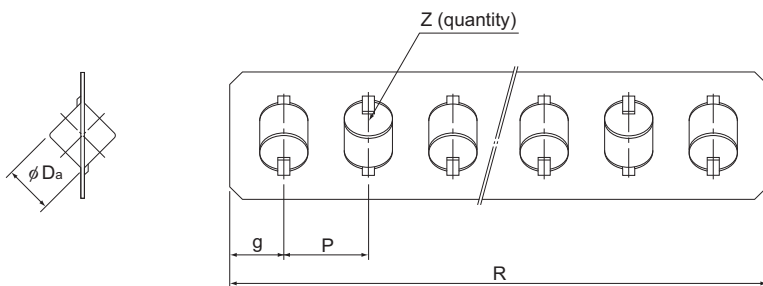

Unit: mm

								No. of rollers Z	Permissible preload δ μm	Basic load rating (per roller)		Mass (rail) kg/m
D	h	T	D_a	R	g	P	C_z kN			C_{oz} kN		
4.4	2	1.5	2	21	2.5	4	5	-3	0.276	0.271	0.23	
				33			8					
				45			11					
				53			13					
				65			16					
				73			18					
				85			21					
				93			23					
				105			26					
				117			29					
			129			32						

Notes: When desiring a Ball Guide in combination with a ball cage, refer to **A7-26** on Ball Cage Model B and indicate the required number of balls.

(Example) VB2-90H x 15Z

Number of balls

The mass in the table indicates the value per rail/m.

Stainless steel type with high corrosion resistance is also available. (symbol M, e.g., VR2M)

To fix the dedicated rail of model VR2, use cross-recessed screws.

Model No.	Type	Nominal name of screw \times pitch
For model VR2	Pan Head Screw ¹	M2 \times 0.4

¹ Cross-recessed screw JIS B 1111 (pan head screw)

Cross-Roller Guide Model VR (VR3)

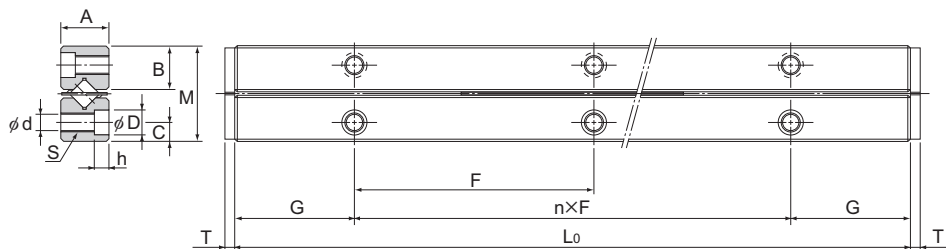

Model No.	Maximum stroke	Main dimensions								
		Combined dimensions			Mounting dimensions					
		M	A	L ₀	n×F	G	B	C	S	d
VR 3- 50×7Z	28	18	8	50	1×25	12.5	8.3	3.5	M4	3.3
VR 3- 75×10Z	48			75	2×25					
VR 3-100×14Z	58			100	3×25					
VR 3-125×17Z	78			125	4×25					
VR 3-150×21Z	88			150	5×25					
VR 3-175×24Z	108			175	6×25					
VR 3-200×28Z	118			200	7×25					
VR 3-225×31Z	138			225	8×25					
VR 3-250×35Z	148			250	9×25					
VR 3-275×38Z	168			275	10×25					
VR 3-300×42Z	178			300	11×25					

Model number coding

VR3 -75 H × 9Z

Number of rollers or balls
Accuracy symbol
Dedicated rail dimension in mm
(example of indication for a combination of different overall lengths: 100/125)
Combined model number (for Ball Guide: VB)

Note: "1 set" for the above model indicates a single combination of 4 rails and 2 cages.

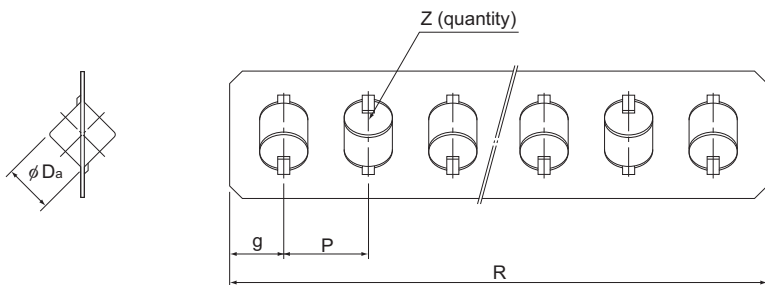

Unit: mm

								Permissible preload δ μm	Basic load rating (per roller)		Mass (rail) kg/m
				No. of rollers Z					C_z kN	C_{0z} kN	
D	h	T	D_a	R	g	P	Z				
6	3.1	2	3	36	3	5	7	-4	0.639	0.611	0.45
				51			10				
				71			14				
				86			17				
				106			21				
				121			24				
				141			28				
				156			31				
				176			35				
				191			38				
211	42										

Notes: When desiring a Ball Guide in combination with a ball cage, refer to **A7-26** on Ball Cage Model B and indicate the required number of balls.

(Example) VB3-150H x 20Z

Number of balls

The mass in the table indicates the value per rail/m.

Stainless steel type with high corrosion resistance is also available. (symbol M, e.g., VR3M)

Cross-Roller Guide Model VR (VR4)

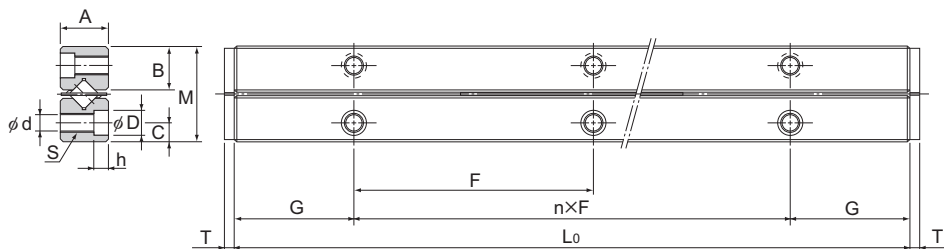

Model No.	Maximum stroke	Main dimensions								
		Combined dimensions			Mounting dimensions					
		M	A	L ₀	n×F	G	B	C	S	d
VR 4-80×7Z	58	22	11	80	1×40	20	10.2	4.5	M5	4.3
VR 4-120×11Z	82			120	2×40					
VR 4-160×15Z	106			160	3×40					
VR 4-200×19Z	130			200	4×40					
VR 4-240×23Z	154			240	5×40					
VR 4-280×27Z	178			280	6×40					
VR 4-320×31Z	202			320	7×40					
VR 4-360×35Z	226			360	8×40					
VR 4-400×39Z	250			400	9×40					
VR 4-440×43Z	274			440	10×40					
VR 4-480×47Z	298			480	11×40					

Model number coding

VR4 -80 P × 9Z

Number of rollers or balls

Accuracy symbol

Dedicated rail dimension in mm

(example of indication for a combination of different overall lengths: 120/160)

Combined model number (for Ball Guide: VB)

Note: "1 set" for the above model indicates a single combination of 4 rails and 2 cages.

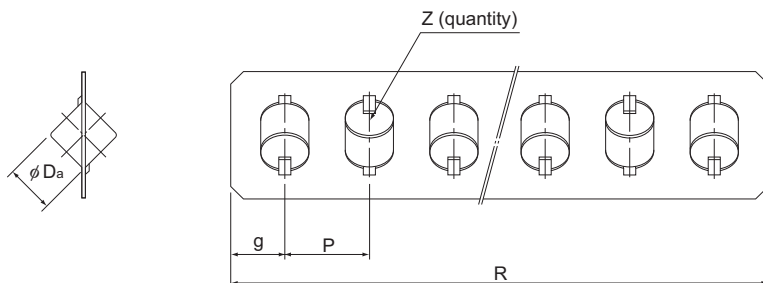

Unit: mm

								No. of rollers Z	Permissible preload δ μm	Basic load rating (per roller)		Mass (rail) kg/m
D	h	T	D_a	R	g	P	C_z kN			C_{0z} kN		
8	4.2	2	4	51	4.5	7	7	-5	1.38	1.35	0.8	
				79			11					
				107			15					
				135			19					
				163			23					
				191			27					
				219			31					
				247			35					
				275			39					
				303			43					
				331			47					

Notes: When desiring a Ball Guide in combination with a ball cage, refer to **A7-26** on Ball Cage Model B and indicate the required number of balls.

(Example) VB4-200H x 17Z

Number of balls

The mass in the table indicates the value per rail/m.

Stainless steel type with high corrosion resistance is also available. (symbol M, e.g., VR4M)

Cross-Roller Guide Model VR (VR6)

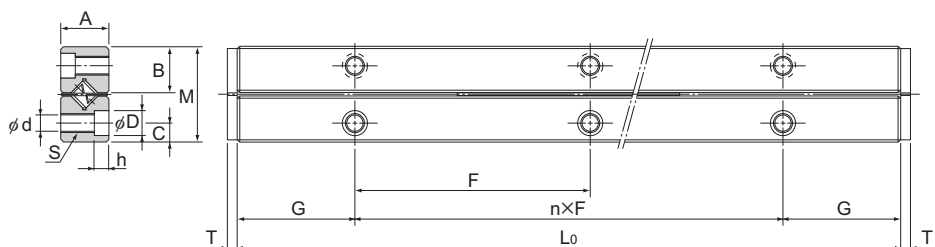

Model No.	Maximum stroke	Main dimensions								
		Combined dimensions			Mounting dimensions					
		M	A	L ₀	n×F	G	B	C	S	d
VR 6-100×7Z	56	30	15	100	1×50	25	14.4	6	M6	5.2
VR 6-150×10Z	96			150	2×50					
VR 6-200×13Z	136			200	3×50					
VR 6-250×17Z	156			250	4×50					
VR 6-300×20Z	196			300	5×50					
VR 6-350×24Z	216			350	6×50					
VR 6-400×27Z	256			400	7×50					
VR 6-450×31Z	276			450	8×50					
VR 6-500×34Z	316			500	9×50					
VR 6-550×38Z	336			550	10×50					
VR 6-600×41Z	376			600	11×50					

Model number coding

VR6 -100 P × 6Z

Number of rollers or balls
 Accuracy symbol
 Dedicated rail dimension in mm
 (example of indication for a combination of different overall lengths: 300/400)
 Combined model number (for Ball Guide: VB)

Note: "1 set" for the above model indicates a single combination of 4 rails and 2 cages.

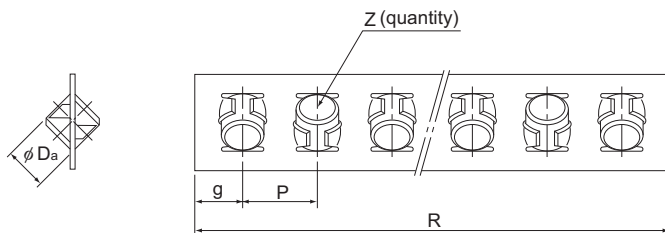

Unit: mm

								Permissible preload δ μm	Basic load rating (per roller)		Mass (rail) kg/m
				No. of rollers Z					C_z kN	C_{0z} kN	
D	h	T	D_a	R	g	P	Z				
9.5	5.2	3.2	6	72	6	10	7	-7	3.78	3.78	1.5
				102			10				
				132			13				
				172			17				
				202			20				
				242			24				
				272			27				
				312			31				
				342			34				
				382			38				
				412			41				

Notes: When desiring a Ball Guide in combination with a ball cage, refer to **A7-26** on Ball Cage Model B and indicate the required number of balls.

(Example) VB6-300H x18Z

Number of balls

The mass in the table indicates the value per rail/m.

Stainless steel type with high corrosion resistance is also available. (symbol M, e.g., VR6M)

Cross-Roller Guide Model VR (VR9)

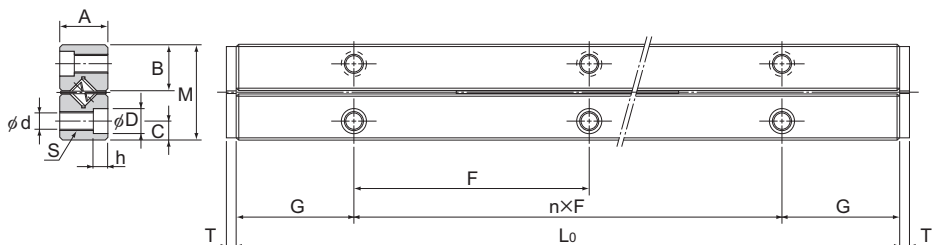

Model No.	Maximum stroke	Main dimensions								
		Combined dimensions			Mounting dimensions					
		M	A	L ₀	n×F	G	B	C	S	d
VR 9- 200×10Z	118	40 (40.74)	20	200	1×100	50	19.2	8	M8	6.8
VR 9- 300×15Z	178			300	2×100					
VR 9- 400×20Z	238			400	3×100					
VR 9- 500×25Z	298			500	4×100					
VR 9- 600×30Z	358			600	5×100					
VR 9- 700×35Z	418			700	6×100					
VR 9- 800×40Z	478			800	7×100					
VR 9- 900×45Z	538			900	8×100					
VR 9-1000×50Z	598			1000	9×100					
VR 9-1100×55Z	658			1100	10×100					
VR 9-1200×60Z	718			1200	11×100					

Model number coding

VR9 -600 H × 30Z

Number of rollers or balls
Accuracy symbol
Dedicated rail dimension in mm
(example of indication for a combination of different overall lengths: 300/400)
Combined model number (for Ball Guide: VB)

Note: "1 set" for the above model indicates a single combination of 4 rails and 2 cages.

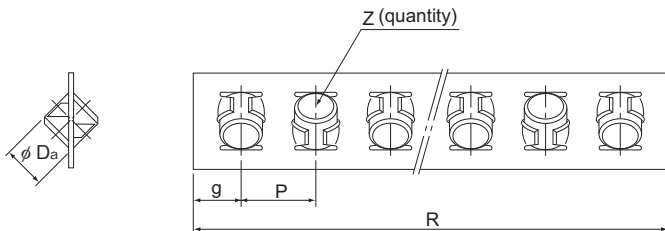

Unit: mm

								No. of rollers Z	Permissible preload δ μm	Basic load rating (per roller)		Mass (rail) kg/m
D	h	T	D_a	R	g	P	C_z kN			C_{oz} kN		
10.5	6.2	4	9 (9.525)	141	7.5	14	10	-10	9.53	9.48	3.2	
				211			15					
				281			20					
				351			25					
				421			30					
				491			35					
				561			40					
				631			45					
				701			50					
				771			55					
				841			60					

Notes: The dimensions in the parentheses above indicate the dimensions of the Ball Guide.

When desiring a Ball Guide in combination with a ball cage, refer to **A7-26** on Ball Cage Model B and indicate the required number of balls.

(Example) VB9-700H x 33Z
└─── Number of balls

The mass in the table indicates the value per rail/m.

Stainless steel type with high corrosion resistance is also available. (symbol M, e.g., VR9M)

Cross-Roller Guide Model VR (VR12)

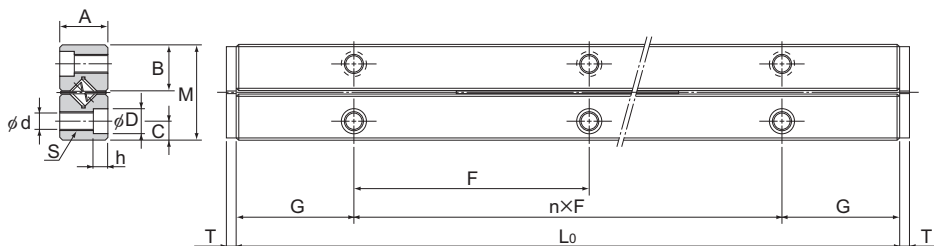

Model No.	Maximum stroke	Main dimensions								
		Combined dimensions			Mounting dimensions					
		M	A	L ₀	n×F	G	B	C	S	d
VR12-200×7Z	110	58 (57.86)	28	200	1×100	50	28	12	M10	8.5
VR12-300×10Z	190			300	2×100					
VR12-400×14Z	230			400	3×100					
VR12-500×17Z	310			500	4×100					
VR12-600×21Z	350			600	5×100					
VR12-700×24Z	430			700	6×100					
VR12-800×28Z	470			800	7×100					
VR12-900×31Z	550			900	8×100					
VR12-1000×34Z	630			1000	9×100					
VR12-1100×38Z	670			1100	10×100					
VR12-1200×41Z	750			1200	11×100					

Model number coding

VR12 -200 P × 9Z

Number of rollers or balls
Accuracy symbol

Dedicated rail dimension in mm
(example of indication for a combination of different overall lengths: 300/400)

Combined model number (for Ball Guide: VB)

Note: "1 set" for the above model indicates a single combination of 4 rails and 2 cages.

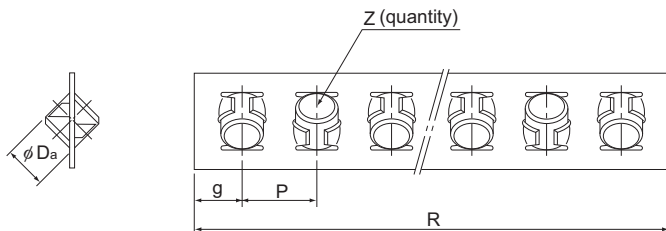

Unit: mm

								Permissible preload δ μm	Basic load rating (per roller)		Mass (rail) kg/m
				No. of rollers					C_z kN	C_{0z} kN	
D	h	T	D_a	R	g	P	Z				
14	8.2	5	12 (11.906)	145	12.5	20	7	-13	17.6	17.2	5.3
				205			10				
				285			14				
				345			17				
				425			21				
				485			24				
				565			28				
				625			31				
				685			34				
				765			38				
				825			41				

Notes: The dimensions in the parentheses above indicate the dimensions of the Ball Guide.
When desiring a Ball Guide in combination with a ball cage, refer to **A7-26** on Ball Cage Model B and indicate the required number of balls.

(Example) VB12-700H x $\underline{20Z}$
└─── Number of balls

The mass in the table indicates the value per rail/m.
Stainless steel type with high corrosion resistance is also available. (symbol M, e.g., VR12M)

Cross-Roller Guide Model VR (VR15)

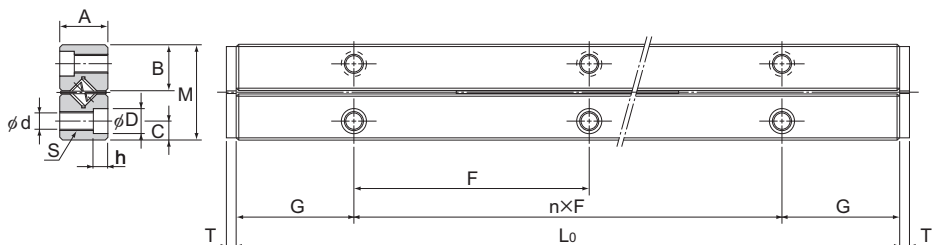

Model No.	Maximum stroke	Main dimensions								
		Combined dimensions			Mounting dimensions					
		M	A	L ₀	n×F	G	B	C	S	d
VR15- 300× 8Z	190	71 (71.11)	36	300	2×100	50	34.4	14	M12	10.5
VR15- 400×11Z	240			400	3×100					
VR15- 500×13Z	340			500	4×100					
VR15- 600×16Z	390			600	5×100					
VR15- 700×19Z	440			700	6×100					
VR15- 800×22Z	490			800	7×100					
VR15- 900×25Z	540			900	8×100					
VR15-1000×27Z	640			1000	9×100					
VR15-1100×30Z	690			1100	10×100					
VR15-1200×33Z	740			1200	11×100					

Model number coding

VR15 -300 H × 10Z

Number of rollers or balls

Accuracy symbol

Dedicated rail dimension in mm

(example of indication for a combination of different overall lengths: 300/400)

Combined model number (for Ball Guide: VB)

Note: "1 set" for the above model indicates a single combination of 4 rails and 2 cages.

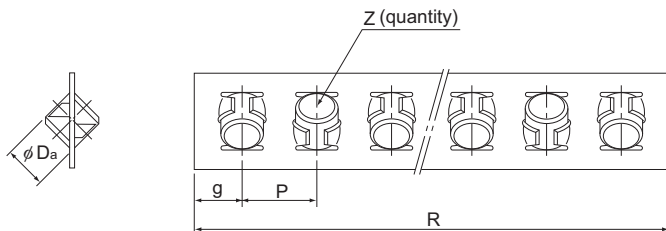

Unit: mm

								Permissible preload δ μm	Basic load rating (per roller)		Mass (rail) kg/m
				No. of rollers Z					C_z kN	C_{0z} kN	
D	h	T	D_a	R	g	P					
17.5	10.2	6	15 (15.081)	205	15	25	8	-16	27.9	26.8	8.3
							11				
							13				
							16				
							19				
							22				
							25				
							27				
							30				
							33				

Notes: The dimensions in the parentheses above indicate the dimensions of the Ball Guide.
When desiring a Ball Guide in combination with a ball cage, refer to **A7-26** on Ball Cage Model B and indicate the required number of balls.

(Example) VB15-800H x 20Z

Number of balls

The mass in the table indicates the value per rail/m.

Stainless steel type with high corrosion resistance is also available. (symbol M, e.g., VR15M)

Cross-Roller Guide Model VR (VR18)

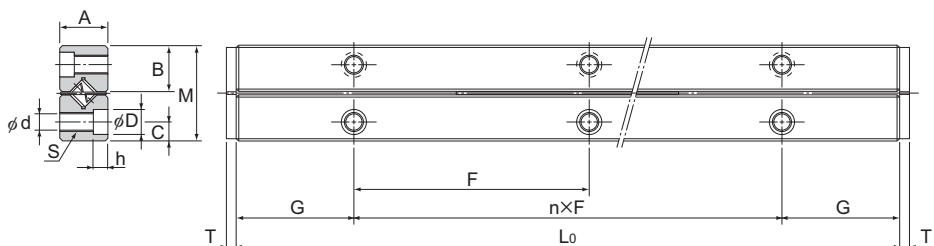

Model No.	Maximum stroke	Main dimensions								
		Combined dimensions			Mounting dimensions					
		M	A	L ₀	n×F	G	B	C	S	d
VR18-300×6Z	228	83	40	300	2×100	50	40.2	18	M14	12.5
VR18-400×9Z	248			400	3×100					
VR18-500×11Z	328			500	4×100					
VR18-600×13Z	408			600	5×100					
VR18-700×16Z	428			700	6×100					
VR18-800×18Z	508			800	7×100					
VR18-900×20Z	588			900	8×100					
VR18-1000×23Z	608			1000	9×100					
VR18-1100×25Z	688			1100	10×100					
VR18-1200×27Z	768			1200	11×100					

Model number coding

VR18 -400 H × 10Z

Number of rollers or balls
Accuracy symbol

Dedicated rail dimension in mm
(example of indication for a combination of different overall lengths: 300/400)

Combined model number (for Ball Guide: VB)

Note: "1 set" for the above model indicates a single combination of 4 rails and 2 cages.

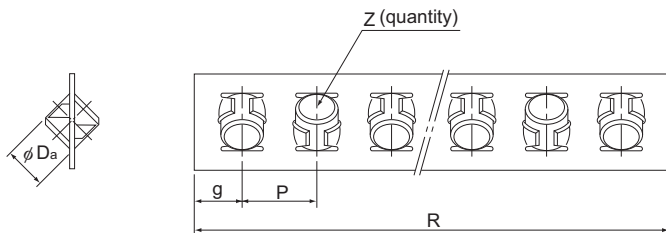

Unit: mm

								No. of rollers Z	Permissible preload δ μm	Basic load rating (per roller)		Mass (rail) kg/m
D	h	T	D_a	R	g	P	C_z kN			C_{0z} kN		
20	12.2	6	18	186	18	30	6	-18	40.9	38.8	10.5	
				276			9					
				336			11					
				396			13					
				486			16					
				546			18					
				606			20					
				696			23					
				756			25					
				816			27					

Notes: The mass in the table indicates the value per rail/m.

Stainless steel type with high corrosion resistance is also available. (symbol M, e.g., VR18M)

Ball Cage Model B

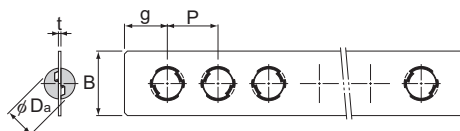

Unit: mm

Model No.	Main dimensions					Basic load rating (per ball)		Combined rail
	D_s	t	B	P	g	C_z N	C_{oz} N	
B 1	1.5	0.2	3.5	2.5	2	7.84	21.6	V1
B 2	2	0.3	5	4	3	12.7	39.2	V2
B 3	3	0.4	7	6	4.5	27.5	87.3	V3
B 4	4	0.5	9	7	4.5	45.1	155	V4
B 6	6	0.6	13.5	10	6	98	353	V6
B 9	9.525	1	19	14	8.5	216	784	V9
B 12	11.906	1	25	20	12.5	324	1420	V12
B 15	15.081	1.2	31	25	15	490	2160	V15

Installation Procedure

When using clearance adjustment bolts:

- (1) Closely contact rails 2 and 3 onto the base, and rail 1 onto the table, and then firmly tighten the rail mounting bolts.
- (2) Temporarily fasten rail 4 to the table.
 Note: The rail mounting bolts must be designed so that they can be fully fastened while maintaining the rail installed.

- (3) Place the base and the tables as shown in Fig.1, and then insert the roller cage from the end. If the cage does not enter because there is no clearance, slide rail 4 toward the adjustment bolt first, and then insert the cage again.
- (4) Place a dial gauge as shown in Fig.1. Then, lightly screw all adjustment bolts evenly until the clearance is almost eliminated while gently pressing the table sideways.
- (5) Attach the stopper to the rail end.
- (6) Slide the table and adjust the cage position so as to achieve the required stroke.
- (7) Position the roller cage in the center of the rail as shown in Fig.2-1. Then, evenly tighten the adjustment bolts (b, c and d) that are within the area where the roller is present until the dial gauge indicates the required displacement. Fully fasten the mounting bolts where adjustment was performed.

Note: The displacement indicated on the gauge represents the preload per roller cage.

- (8) Slide the table as shown in Fig.2-2, and adjust the remaining adjustment bolts (a and e) in the same manner.

Note: When installing two or more units, first measure the tightening torque of the adjustment bolts for the first unit or the sliding resistance of the first unit. Then, install the second (and later) unit so that its/their tightening torque(s) or sliding resistance(s) equal(s) that of the first unit. In this way, almost uniform preloads can be provided.

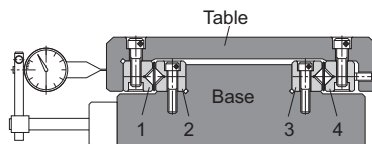

Fig.1 Installation of the Cross-Roller Guide

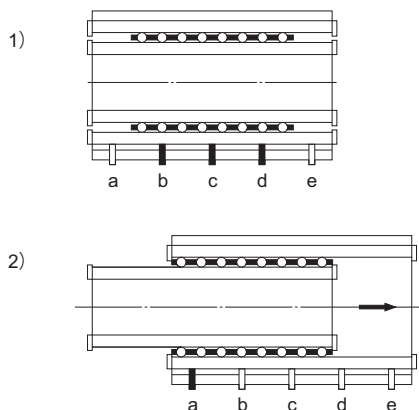
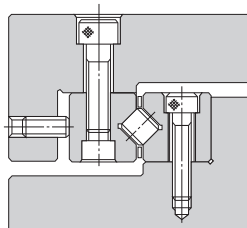

Fig.2 Sequence of Tightening the Adjustment Bolts

Example of Clearance Adjustment

Design the adjustment bolt so that it presses the rail on the same level as the roller.



Normally, press the rail with the adjustment bolt.

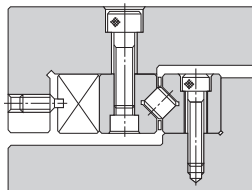

When a certain level of accuracy and rigidity is required, use a presser plate.

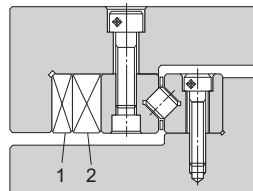

When high accuracy and high rigidity are required, use tapered gibs 1 and 2.

Fig.3 Example of Clearance Adjustment

Preload

An excessive preload may cause indentation, shorten the service life or cause trouble. The permissible preload per roller cage is indicated in the specification table. Tighten the adjustment bolts while monitoring the displacement of the roller contact area.

Accuracy of the Mounting Surface

To achieve a high level of running accuracy, it is also necessary to establish a certain level of accuracy in parallelism and straightness. Preferably, the parallelism and the flatness of the rail-mounting surface should be finished by grinding or similar machining to at least the same degree as the parallelism of the rail (see **A7-7**). Also, mount the rail so that it closely contacts the mounting surface.

Dedicated Mounting Bolt

To mount the rail where normal clearance is to be adjusted, use the screw hole drilled on the rail as shown in Fig.1. The holes of the bolt (d_1 and D_1) must be machined so that they are greater by the adjustment allowance.

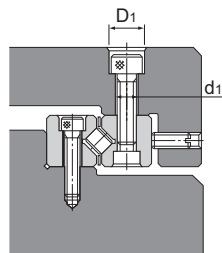

Fig.1

If it is inevitable to adopt a mounting method like the one shown in Fig.2 for a structural reason, use the dedicated mounting bolt (S) indicated in Fig.3.

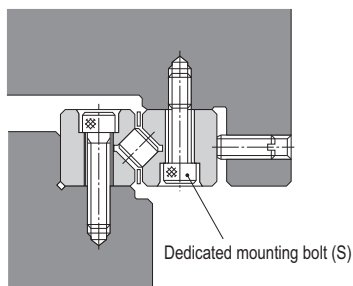

Fig.2

Table1 Dedicated Mounting Bolt

Unit: mm

Model No.	S	d	D	H	L	B	Mass [g]	Supported rail
S 3	M3	2.3	5	3	12	2.5	1	V3
S 4	M4	3.1	5.8	4	15	3	2	V4
S 6	M5	3.9	8	5	20	4	4	V6
S 9	M6	4.6	8.5	6	30	5	5	V9
S 12	M8	6.25	11.3	8	40	6	15	V12
S 15	M10	7.9	13.9	10	45	8	27	V15
S 18	M12	9.6	15.8	12	50	10	43	V18

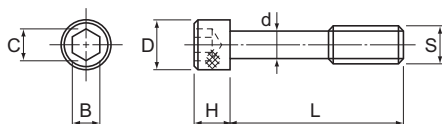

Fig.3 Dedicated Mounting Bolt

Model Number Coding

Model number configurations differ depending on the model features. Refer to the corresponding sample model number configuration.

[Cross-Roller Guide/Ball Guide]

● Models VR and VB

VR1 M -30 H × 8Z

No Symbol:

Carbon steel
(standard)

M: Stainless steel

H : High accuracy grade

P : Precision grade

Number of rollers or balls

Dedicated rail dimension in mm (example of indication for a combination of different overall lengths: 40/50)

Combined model number (for Ball Guide: VB)

Note: "1 set" for the above model indicates a single combination of 4 rails and 2 cages.

- Dedicated rail only

V6 -200

Model No. Dedicated rail dimension in mm

- Roller cage only

R6 × 13Z

Model number Number of rollers or balls
(Roller : R
Ball : B)

- Dedicated mounting bolt

S6

Model No. For the compatibility chart, see **A7-30**

Note: When purchasing only dedicated rails, roller cages, or dedicated mounting bolts, please specify the quantity separately.

Notes on Ordering

[Order units]

“One set” of cross-roller guides or ball guides denotes a combination of four rails and two cages.

● Sample cross-roller guide and ball guide orders

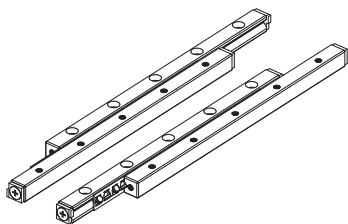

VR12 -400 P × 14Z 1 set

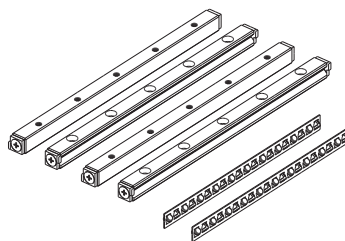

1 set consists of 4 rails and 2 cages

Note: For information on rail and cage product combinations other than those listed in the specification tables, contact THK.

[Handling]

- (1) Do not disassemble the parts. This will result in loss of functionality.
- (2) Take care not to drop or strike the Cross-Roller Guide/Ball Guide. Doing so may cause injury or damage. Giving an impact to it could also cause damage to its function even if the product looks intact.
- (3) When handling the product, wear protective gloves, safety shoes, etc., as necessary to ensure safety.

[Precautions on Use]

- (1) Prevent foreign material, such as cutting chips or coolant, from entering the product. Failure to do so may cause damage.
- (2) If the product is used in an environment where cutting chips, corrosive solvents, water, etc., may enter the product, use bellows, covers, etc., to prevent them from entering the product.
- (3) If foreign material such as cutting chips adheres to the product, replenish the lubricant after cleaning the product.
- (4) Do not use the product at temperature of 100°C or higher.
- (5) Micro-strokes tend to obstruct oil film to form on the raceway in contact with the rolling element, and may lead to fretting corrosion. Take consideration using grease offering excellent fretting prevention. THK also recommends periodically executing a full stroke with the unit to ensure that the raceway and balls are coated with lubricant.
- (6) Do not use undue force when fitting parts (pin, key, etc.) to the product. This may generate permanent deformation on the raceway, leading to loss of functionality.
- (7) Using the product with some of the rolling elements missing may cause damage at an early stage.
- (8) If any of the rolling elements falls, contact THK instead of using the product.
- (9) Insufficient rigidity or accuracy of mounting members causes the bearing load to concentrate on one point and the bearing performance will drop significantly. Accordingly, give sufficient consideration to the rigidity/accuracy of the housing and base and strength of the fixing bolts.

[Lubrication]

- (1) Thoroughly wipe off anti-rust oil and feed lubricant before using the product.
- (2) When lubricating the product, apply grease directly on the raceway and stroke the product several times to let the grease spread inside.
- (3) Do not mix different lubricants. Mixing greases using the same type of thickening agent may still cause adverse interaction between the two greases if they use different additives, etc.
- (4) When using the product in locations exposed to constant vibrations or in special environments such as clean rooms, vacuum and low/high temperature, use the grease appropriate for the specification/environment.
- (5) The consistency of grease changes according to the temperature. Take note that the slide resistance of the Cross-Roller Guide/Ball Guide also changes as the consistency of grease changes.
- (6) After lubrication, the slide resistance of the Cross-Roller Guide/Ball Guide may increase due to the agitation resistance of grease. Be sure to perform a break-in to let the grease spread fully, before operating the machine.
- (7) Excess grease may scatter immediately after lubrication, so wipe off scattered grease as necessary.

- (8) The properties of grease deteriorate and its lubrication performance drops over time, so grease must be checked and added properly according to the use frequency of the machine.
- (9) The greasing interval varies depending on the use condition and service environment. Set the final lubrication interval/amount based on the actual machine.

[Installation]

If the counterbore hole on the Cross-Roller Guide is being used to anchor the rail, use a hexagonal-head bolt (JIS B 1176). However, for the models listed in Table1, THK's recommendations for screws are shown.

Table1 Anchoring screws

Model	Type	Nominal name of screw × pitch
VR1	No. 0 pan-head screw ¹ (class 3)	M1.4 × 0.3
VR2	Cross-recessed pan head screw ²	M2 × 0.4

¹ Japan Camera Industry Association Standard JCIS 10-70
Phillips screw for precision equipment (No. 0 screw)

² Phillips pan head screw JIS B 1111

[Rail Length]

The roller cage and the ball cage move half the travel distance of the table in the same direction.

To prevent the cage from overhanging from the raceway base when the cage length is " l " and the stroke length is " l_s ", the rail length (L_k) must be at least the following.

$$L_k \geq l + \frac{l_s}{2}$$

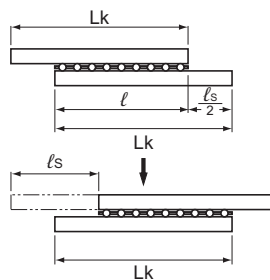

Fig.1

[Offset of the Cage]

The cage, which retains rollers (or balls), demonstrates extremely accurate motion. However, it may be offset as affected by driving vibrations, inertia or impact.

When desiring to use the product in a following condition, contact THK.

- Vertical use
- Pneumatic cylinder drive
- Cam drive
- High speed crank drive
- Under a large moment load
- Butting the guide's external stopper with the table

[Stopper]

Stoppers are attached to the rail ends in order to prevent the cage from falling off. Note, however, that frequently colliding the cage with the stopper may cause wear of the stopper and loosening of the stopper fastening screws, and may cause the cage to fall off.

[Contamination protection]

As a means to prevent foreign material from entering the Cross-Roller Guide or the Ball Guide, contamination protection accessories for the side faces as shown in Fig.2 are available. For contamination protection in the front and rear directions, consider using a bellows or a telescopic cover.

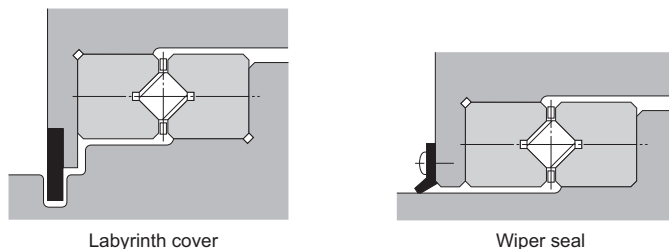

Fig.2 Contamination Protection Methods

[Storage]

When storing the Cross-Roller Guide•Ball Guide, enclose it in a package designated by THK and store it in a room in a horizontal orientation while avoiding high temperature, low temperature and high humidity.

If you request that we do not apply anti-rust oil to a product, please be aware that it may rust due to the storage environment or length of storage.

[Disposal]

Dispose of the product properly as industrial waste.



Cross-Roller Guide/Ball Guide

THK General Catalog

B Support Book

Features and Types	A7-2
Features of the Cross-Roller Guide/Ball Guide ..	A7-2
• Structure and Features	A7-2
Types of the Cross-Roller Guide/Ball Guide ..	A7-3
• Types and Features	A7-3
Point of Selection	A7-4
Rated Load and Nominal Life	A7-4
Mounting Procedure	A7-7
Installation Procedure	A7-7
Example of Clearance Adjustment	A7-8
Preload	A7-8
Accuracy of the Mounting Surface.....	A7-8
Options	A7-9
Dedicated Mounting Bolt	A7-9
Model No.	A7-10
• Model Number Coding	A7-10
• Notes on Ordering	A7-11
Precautions on Use	A7-12

A Product Descriptions (Separate)

Features and Types	A7-2
Features of the Cross-Roller Guide/Ball Guide ..	A7-2
• Structure and Features	A7-2
Types of the Cross-Roller Guide/Ball Guide ..	A7-3
• Types and Features	A7-3
Point of Selection	A7-4
Rated Load and Nominal Life	A7-4
Accuracy Standards	A7-7
Dimensional Drawing, Dimensional Table	
Cross-Roller Guide Model VR (VR1) ..	A7-8
Cross-Roller Guide Model VR (VR2) ..	A7-10
Cross-Roller Guide Model VR (VR3) ..	A7-12
Cross-Roller Guide Model VR (VR4) ..	A7-14
Cross-Roller Guide Model VR (VR6) ..	A7-16
Cross-Roller Guide Model VR (VR9) ..	A7-18
Cross-Roller Guide Model VR (VR12) ..	A7-20
Cross-Roller Guide Model VR (VR15) ..	A7-22
Cross-Roller Guide Model VR (VR18) ..	A7-24
Ball Cage Model B	A7-26
Point of Design	A7-28
Installation Procedure	A7-28
Example of Clearance Adjustment	A7-29
Preload	A7-29
Accuracy of the Mounting Surface.....	A7-29
Options	A7-30
Dedicated Mounting Bolt	A7-30
Model No.	A7-31
• Model Number Coding	A7-31
• Notes on Ordering	A7-32
Precautions on Use	A7-33

Features of the Cross-Roller Guide/Ball Guide

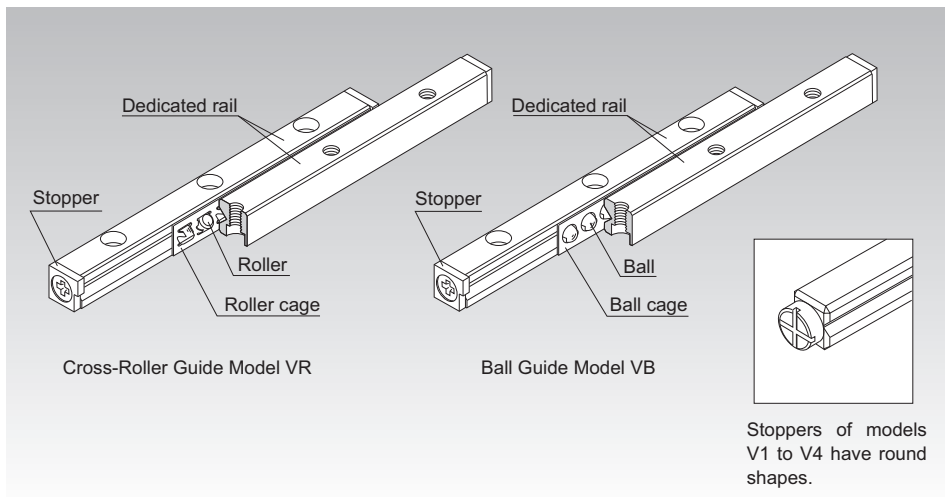

Fig.1 Structure of Cross-Roller Guide Model VR and Ball Guide Model VB

Structure and Features

In the Model VR, precision rollers are orthogonally aligned one after another in a roller cage that is combined with a dedicated rail that has a raceway cut into a 90° V-shaped groove. When two cross-roller guides are mounted in parallel, they are capable of receiving loads in four directions. In addition, the cross-roller guide can be given a preload to achieve a clearance-free, highly rigid, and smooth slide mechanism.

Model VB is a low-friction, high-accuracy, finite LM system consisting of precision steel balls, arranged in short pitches in a ball cage model B, and a dedicated rail model V.

The Cross-Roller Guide and the Ball Guide are used in the slide unit of various devices such as OA equipment and its peripherals, measuring instruments, precision equipment including a printed circuit board drilling machine, optic measuring machines, optic stages, handling mechanisms and X-Ray machines.

Features and Types

Types of the Cross-Roller Guide/Ball Guide

[Long Service Life, High Rigidity]

With a unique roller retaining mechanism, the effective contact length of the rollers is 1.7 times greater than the conventional type. Furthermore, the roller pitch interval is short and a sufficient number of rollers are installed, thereby doubling the rigidity and increasing the service life by a factor of 6. As a result, a safety-oriented design against vibrations and impacts, which commonly occur in ordinary linear motion mechanisms, can be achieved.

[Smooth Motion]

With model VR, the rollers are individually held in a cage and roller pockets formed on the cage are in surface contact with the rollers to increase grease retention. Thus, smooth motion with little wear and friction is achieved.

[Highly Corrosion Resistant]

Model VR series and model VB series both include types made of stainless steel, which is highly corrosion resistant.

Types of the Cross-Roller Guide/Ball Guide

Types and Features

Cross-Roller Guide Model VR

Specification Table⇒ [A7-8](#)

A compact, highly rigid LM system whose roller cage holding precision rollers orthogonally aligned one after another travels by half the stroke on a V-shaped groove formed on a rail.

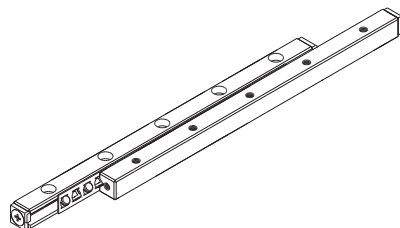

Model VR

Ball Guide Model VB

Specification Table⇒ [A7-26](#)

A low-friction, highly accurate LM system whose ball cage holding precision balls in short pitches travels by half the stroke on a V-shaped groove formed on a rail.

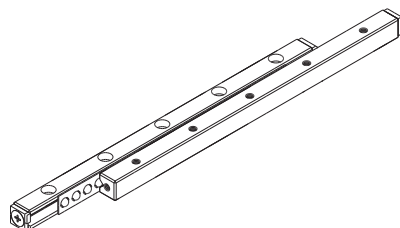

Model VB

Rated Load and Nominal Life

[Rated Loads in All Directions]

The basic load ratings (C_z and C_{0z}) in the specification table indicate the values per rolling element in the directions shown in the figure. When obtaining the nominal life, calculate the basic load ratings (C and C_0) of the actually used rolling elements from the equation below.

C_z : Basic dynamic load rating per rolling element in the specification table (kN)

C_{0z} : Basic static load rating per rolling element in the specification table (kN)

Z : Number of rolling elements used (number of rolling elements within the effective load range)

P : Roller pitch (Refer to pages **A7-8** to **A7-25**)

● For Model VR

Load direction		
Basic dynamic load rating C (kN)	$C = C_L = \left\{ \left(\frac{Z}{2} - 1 \right) \times 2P \right\}^{\frac{1}{36}} \times \left(\frac{Z}{2} \right)^3 \times C_z$	$C_T = 2^{\frac{7}{9}} \times \left\{ \left(\frac{Z}{2} - 1 \right) \times 2P \right\}^{\frac{1}{36}} \times \left(\frac{Z}{2} \right)^3 \times C_z$
Basic static load rating C_0 (kN)	$C_0 = C_{0L} = \frac{Z}{2} \times C_{0z}$	$C_{0T} = 2 \times \frac{Z}{2} \times C_{0z}$

Note: For $\frac{Z}{2}$, truncate the decimals.

● For Model VB

Load direction		
Basic dynamic load rating C (kN)	$C = C_L = Z^{\frac{2}{3}} \times C_z$	$C_T = 2 \times Z^{\frac{2}{3}} \times C_z$
Basic static load rating C_0 (kN)	$C_0 = C_{0L} = Z \times C_{0z}$	$C_{0T} = 2 \times Z \times C_{0z}$

[Static Safety Factor f_s]

Models VR and VB may receive an unexpected external force while it is stationary or operative due to the generation of an inertia caused by vibrations and impact or start and stop. It is necessary to consider a static safety factor against such a working load.

$$f_s = \frac{C_0}{P_c}$$

f_s : Static safety factor (see Table1)
 C_0 : Basic static load rating (kN)
 P_c : Calculated load (kN)

Table1 Estimates of the Static Safety Factor (f_s)

Load conditions ¹	Lower limit of f_s
Without vibration or impact	1 to 1.3
With vibration or impact	2 to 3

¹ Vibrations and impacts are typically caused by factors such as acceleration and deceleration, sudden starting and stopping, vibrations and impacts from an external machine, and changes in processing power over time.

[Calculating the Nominal Life]

The nominal life is defined as 50 km for a THK LM Guide with balls and 100 km for a cross-roller guide. The nominal life (L_{10}) is calculated from the basic dynamic load rating (C) and the load acting on the LM Guide (P_c) using the following formulas.

- LM Guide with balls (50 km basic dynamic load rating)

$$L_{10} = \left(\frac{C}{P_c}\right)^3 \times 50 \quad \dots\dots\dots(1)$$

L_{10} : Nominal life (km)
 C : Basic dynamic load rating (kN)
 P_c : Calculated load (kN)

- LM Guide with rollers (100 km basic dynamic load rating)

$$L_{10} = \left(\frac{C}{P_c}\right)^{\frac{10}{3}} \times 100 \quad \dots\dots\dots(2)$$

When comparing the nominal life (L_{10}), you must take into account whether the basic dynamic load rating was defined based on 50 km or 100 km. Convert the basic dynamic load rating based on ISO 14728-1 as necessary.

ISO-regulated basic dynamic load rating conversion formulas:

- LM Guide with balls

$$C_{100} = \frac{C_{50}}{1.26}$$

C_{50} : Basic dynamic load rating based on a nominal life of 50 km

- LM Guide with rollers

$$C_{100} = \frac{C_{50}}{1.23}$$

C_{100} : Basic dynamic load rating based on a nominal life of 100 km

[Calculating the Modified Nominal Life]

During use, a cross-roller guide/ball guide may be subjected to vibrations and shocks as well as fluctuating loads, which are difficult to detect. In addition, the surface hardness of the raceways, the operating temperature, and having blocks arranged directly behind one another will have a decisive impact on the service life. Taking these factors into account, the modified nominal life (L_{10m}) can be calculated according to the following formulas (3) and (4).

- Modified factor α

$$\alpha = \frac{f_r}{f_w}$$

α : Modified factor
 f_r : Temperature factor (see Fig. 1 on B7-6)
 f_w : Load factor

(see Table 2 on B7-6)

• Modified nominal life L_{10m}

- LM Guide with balls

$$L_{10m} = \left(\alpha \times \frac{C}{P_c} \right)^3 \times 50 \quad \dots\dots\dots(3)$$

L_{10m} : Modified nominal life (km)

C : Basic dynamic load rating (kN)

P_c : Calculated load (kN)

- LM Guide with rollers

$$L_{10m} = \left(\alpha \times \frac{C}{P_c} \right)^{\frac{10}{3}} \times 100 \quad \dots\dots\dots(4)$$

[Calculating the Service Life Time]

When the nominal life (L_{10}) has been obtained, if the stroke length and the number of reciprocations per minute are constant, the service life time is obtained using the following equation.

$$L_h = \frac{L_{10} \times 10^6}{2 \times l_s \times n_1 \times 60}$$

L_h : Service life time (h)

l_s : Stroke length (mm)

n_1 : Number of reciprocations per minute (min^{-1})

● f_T : Temperature Factor

If the temperature of the environment surrounding the operating model VR or VB exceeds 100 °C, take into account the adverse effect of the high temperature and multiply the basic load ratings by the temperature factor indicated in Fig. 1.

Note: If the environment temperature exceeds 100°C, contact THK.

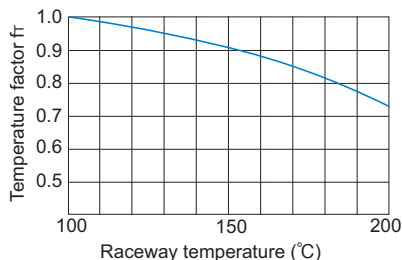

Fig. 1 Temperature Factor (f_T)

● f_w : Load Factor

In general, reciprocating machines tend to experience vibrations or impacts during operation, and it is difficult to accurately determine the vibrations generated during high-speed operation and impacts during frequent starts and stops. Therefore, when the actual load applied to a Model VR or VB cannot be obtained, or when speed and vibrations have a significant influence, divide the basic dynamic load rating (C) by the corresponding load factor in Table 2, which has been empirically obtained.

Table 2 Load Factor (f_w)

Vibrations/impact	Speed (V)	f_w
Faint	Very low $V \leq 0.25\text{m/s}$	1 to 1.2
Weak	Slow $0.25 < V \leq 1\text{m/s}$	1.2 to 1.5

Installation Procedure

When using clearance adjustment bolts:

- (1) Closely contact rails 2 and 3 onto the base, and rail 1 onto the table, and then firmly tighten the rail mounting bolts.
- (2) Temporarily fasten rail 4 to the table.
 Note: The rail mounting bolts must be designed so that they can be fully fastened while maintaining the rail installed.

- (3) Place the base and the tables as shown in Fig.1, and then insert the roller cage from the end. If the cage does not enter because there is no clearance, slide rail 4 toward the adjustment bolt first, and then insert the cage again.

- (4) Place a dial gauge as shown in Fig.1. Then, lightly screw all adjustment bolts evenly until the clearance is almost eliminated while gently pressing the table sideways.

- (5) Attach the stopper to the rail end.
- (6) Slide the table and adjust the cage position so as to achieve the required stroke.

- (7) Position the roller cage in the center of the rail as shown in Fig.2-1. Then, evenly tighten the adjustment bolts (b, c and d) that are within the area where the roller is present until the dial gauge indicates the required displacement. Fully fasten the mounting bolts where adjustment was performed.

Note: The displacement indicated on the gauge represents the preload per roller cage.

- (8) Slide the table as shown in Fig.2-2, and adjust the remaining adjustment bolts (a and e) in the same manner.

Note: When installing two or more units, first measure the tightening torque of the adjustment bolts for the first unit or the sliding resistance of the first unit. Then, install the second (and later) unit so that its/their tightening torque(s) or sliding resistance(s) equal(s) that of the first unit. In this way, almost uniform preloads can be provided.

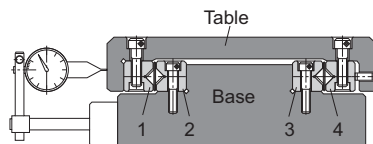

Fig.1 Installation of the Cross-Roller Guide

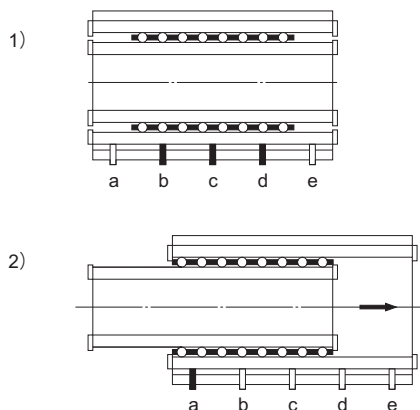
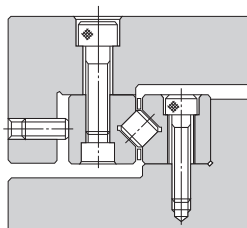

Fig.2 Sequence of Tightening the Adjustment Bolts

Example of Clearance Adjustment

Design the adjustment bolt so that it presses the rail on the same level as the roller.



Normally, press the rail with the adjustment bolt.

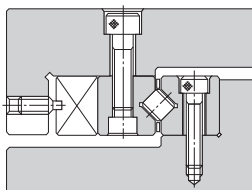

When a certain level of accuracy and rigidity is required, use a presser plate.

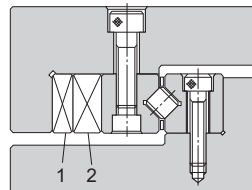

When high accuracy and high rigidity are required, use tapered gibs 1 and 2.

Fig.3 Example of Clearance Adjustment

Preload

An excessive preload may cause indentation, shorten the service life or cause trouble. The permissible preload per roller cage is indicated in the specification table. Tighten the adjustment bolts while monitoring the displacement of the roller contact area.

Accuracy of the Mounting Surface

To achieve a high level of running accuracy, it is also necessary to establish a certain level of accuracy in parallelism and straightness. Preferably, the parallelism and the flatness of the rail-mounting surface should be finished by grinding or similar machining to at least the same degree as the parallelism of the rail (see **A7-7**). Also, mount the rail so that it closely contacts the mounting surface.

Dedicated Mounting Bolt

To mount the rail where normal clearance is to be adjusted, use the screw hole drilled on the rail as shown in Fig.1. The holes of the bolt (d_1 and D_1) must be machined so that they are greater by the adjustment allowance.

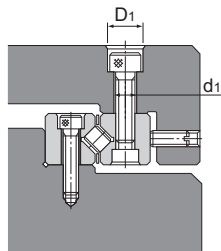

Fig.1

If it is inevitable to adopt a mounting method like the one shown in Fig.2 for a structural reason, use the dedicated mounting bolt (S) indicated in Fig.3.

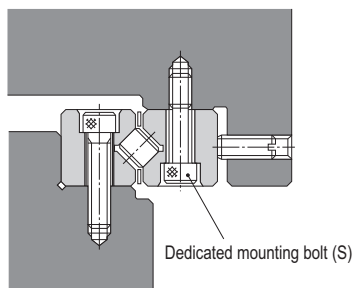

Fig.2

Table1 Dedicated Mounting Bolt

Unit: mm

Model No.	S	d	D	H	L	B	Mass [g]	Supported rail
S 3	M3	2.3	5	3	12	2.5	1	V3
S 4	M4	3.1	5.8	4	15	3	2	V4
S 6	M5	3.9	8	5	20	4	4	V6
S 9	M6	4.6	8.5	6	30	5	5	V9
S 12	M8	6.25	11.3	8	40	6	15	V12
S 15	M10	7.9	13.9	10	45	8	27	V15
S 18	M12	9.6	15.8	12	50	10	43	V18

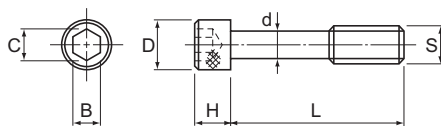

Fig.3 Dedicated Mounting Bolt

Model Number Coding

Model number configurations differ depending on the model features. Refer to the corresponding sample model number configuration.

[Cross-Roller Guide/Ball Guide]

● Models VR and VB

VR1 M -30 H × 8Z

No Symbol:
Carbon steel
(standard)

M: Stainless steel

H : High accuracy grade
P : Precision grade

Number of rollers or balls

Dedicated rail dimension in mm (example of indication for a combination of different overall lengths: 40/50)

Combined model number (for Ball Guide: VB)

Note: "1 set" for the above model indicates a single combination of 4 rails and 2 cages.

- Dedicated rail only

V6 -200

Model No. Dedicated rail dimension in mm

- Roller cage only

R6 × 13Z

Model number Number of rollers or balls
(Roller : R
Ball : B)

- Dedicated mounting bolt

S6

Model No. For the compatibility chart, see **A7-30**

Note: When purchasing only dedicated rails, roller cages, or dedicated mounting bolts, please specify the quantity separately.

Notes on Ordering

[Order units]

“One set” of cross-roller guides or ball guides denotes a combination of four rails and two cages.

● Sample cross-roller guide and ball guide orders

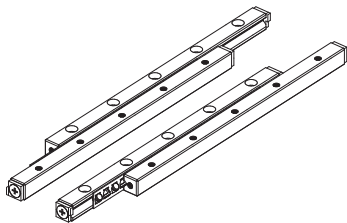

VR12 -400 P × 14Z 1 set

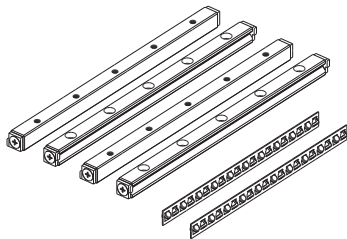

1 set consists of 4 rails and 2 cages

Note: For information on rail and cage product combinations other than those listed in the specification tables, contact THK.

Precautions on Use

Cross-Roller Guide/Ball Guide

[Handling]

- (1) Do not disassemble the parts. This will result in loss of functionality.
- (2) Take care not to drop or strike the Cross-Roller Guide/Ball Guide. Doing so may cause injury or damage. Giving an impact to it could also cause damage to its function even if the product looks intact.
- (3) When handling the product, wear protective gloves, safety shoes, etc., as necessary to ensure safety.

[Precautions on Use]

- (1) Prevent foreign material, such as cutting chips or coolant, from entering the product. Failure to do so may cause damage.
- (2) If the product is used in an environment where cutting chips, corrosive solvents, water, etc., may enter the product, use bellows, covers, etc., to prevent them from entering the product.
- (3) If foreign material such as cutting chips adheres to the product, replenish the lubricant after cleaning the product.
- (4) Do not use the product at temperature of 100°C or higher.
- (5) Micro-strokes tend to obstruct oil film to form on the raceway in contact with the rolling element, and may lead to fretting corrosion. Take consideration using grease offering excellent fretting prevention. THK also recommends periodically executing a full stroke with the unit to ensure that the raceway and balls are coated with lubricant.
- (6) Do not use undue force when fitting parts (pin, key, etc.) to the product. This may generate permanent deformation on the raceway, leading to loss of functionality.
- (7) Using the product with some of the rolling elements missing may cause damage at an early stage.
- (8) If any of the rolling elements falls, contact THK instead of using the product.
- (9) Insufficient rigidity or accuracy of mounting members causes the bearing load to concentrate on one point and the bearing performance will drop significantly. Accordingly, give sufficient consideration to the rigidity/accuracy of the housing and base and strength of the fixing bolts.

[Lubrication]

- (1) Thoroughly wipe off anti-rust oil and feed lubricant before using the product.
- (2) When lubricating the product, apply grease directly on the raceway and stroke the product several times to let the grease spread inside.
- (3) Do not mix different lubricants. Mixing greases using the same type of thickening agent may still cause adverse interaction between the two greases if they use different additives, etc.
- (4) When using the product in locations exposed to constant vibrations or in special environments such as clean rooms, vacuum and low/high temperature, use the grease appropriate for the specification/environment.
- (5) The consistency of grease changes according to the temperature. Take note that the slide resistance of the Cross-Roller Guide/Ball Guide also changes as the consistency of grease changes.
- (6) After lubrication, the slide resistance of the Cross-Roller Guide/Ball Guide may increase due to the agitation resistance of grease. Be sure to perform a break-in to let the grease spread fully, before operating the machine.
- (7) Excess grease may scatter immediately after lubrication, so wipe off scattered grease as necessary.

Precautions on Use

- (8) The properties of grease deteriorate and its lubrication performance drops over time, so grease must be checked and added properly according to the use frequency of the machine.
- (9) The greasing interval varies depending on the use condition and service environment. Set the final lubrication interval/amount based on the actual machine.

[Installation]

If the counterbore hole on the Cross-Roller Guide is being used to anchor the rail, use a hexagonal-head bolt (JIS B 1176). However, for the models listed in Table1, THK's recommendations for screws are shown.

Table1 Anchoring screws

Model	Type	Nominal name of screw × pitch
VR1	No. 0 pan-head screw ¹ (class 3)	M1.4×0.3
VR2	Cross-recessed pan head screw ²	M2×0.4

¹ Japan Camera Industry Association Standard JCIS 10-70 Phillips screw for precision equipment (No. 0 screw)

² Phillips pan head screw JIS B 1111

[Rail Length]

The roller cage and the ball cage move half the travel distance of the table in the same direction.

To prevent the cage from overhanging from the raceway base when the cage length is “ l ” and the stroke length is “ l_s ”, the rail length (L_k) must be at least the following.

$$L_k \geq l + \frac{l_s}{2}$$

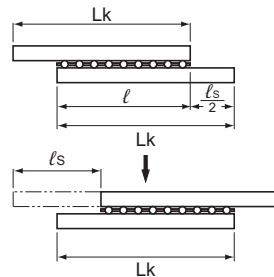

Fig.1

[Offset of the Cage]

The cage, which retains the rollers (or balls), demonstrates extremely accurate motion. However, it may be offset as affected by driving vibrations, inertia or impact.

When desiring to use the product in a following condition, contact THK.

- Vertical use
- Pneumatic cylinder drive
- Cam drive
- High speed crank drive
- Under a large moment load
- Butting the guide's external stopper with the table

[Stopper]

Stoppers are attached to the rail ends in order to prevent the cage from falling off. Note, however, that frequently colliding the cage with the stopper may cause wear of the stopper and loosening of the stopper fastening screws, and may cause the cage to fall off.

[Contamination protection]

As a means to prevent foreign material from entering the Cross-Roller Guide or the Ball Guide, contamination protection accessories for the side faces as shown in Fig.2 are available. For contamination protection in the front and rear directions, consider using a bellows or a telescopic cover.

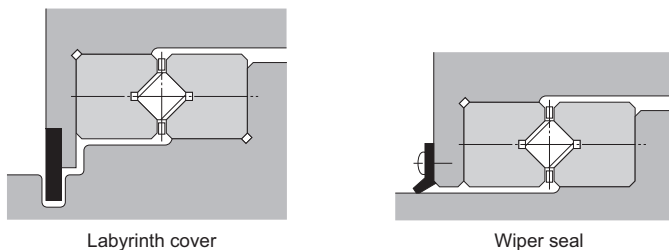

Fig.2 Contamination Protection Methods

[Storage]

When storing the Cross-Roller Guide•Ball Guide, enclose it in a package designated by THK and store it in a room in a horizontal orientation while avoiding high temperature, low temperature and high humidity.

If you request that we do not apply anti-rust oil to a product, please be aware that it may rust due to the storage environment or length of storage.

[Disposal]

Dispose of the product properly as industrial waste.